

DF150P Series

Size : 294 x 235

Unit : mm

2-Speed: High and Low

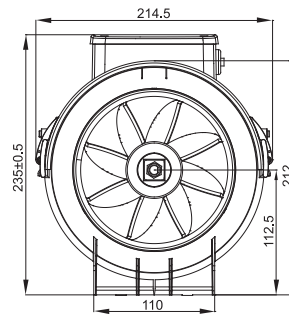
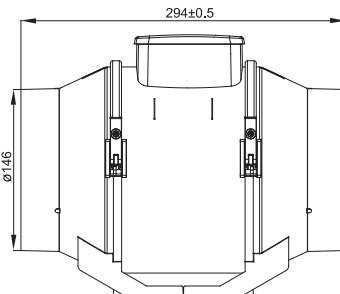

(Duct Fan)

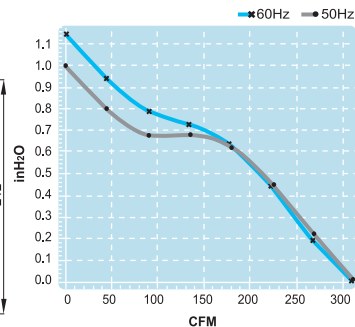

Thermally-Protected



Spec. Model	Rated Voltage V	Frequency Hz	Input Power W	Rated Current A	Locked Current A	Speed RPM	Maximum Air Flow m ³ /min.	Maximum Air Flow CFM	Maximum Pressure mmH ₂ O	Maximum Pressure InchH ₂ O	Noise dB	IP Rate	Weight kg
DF150P11-H	115V	50	65	0.54	0.67	2000	8.5	300	26	1.02	62	44	2.6
		60	75	0.65	0.68	1900	8.2	290	29	1.14	61		
	-L 115V	50	50	0.43	0.46	1400	5.7	200	19	0.75	53		
		60	52	0.46	0.47	1300	5.1	180	17	0.67	50		
DF150P23-H	230V	50	65	0.27	0.32	2000	8.5	300	26	1.02	62	44	2.6
		60	75	0.32	0.33	1900	8.2	290	29	1.14	61		
	-L 230V	50	50	0.21	0.23	1400	5.7	200	19	0.75	53		
		60	52	0.23	0.24	1300	5.1	180	17	0.67	50		